

LuminEsse™

Owner's Manual

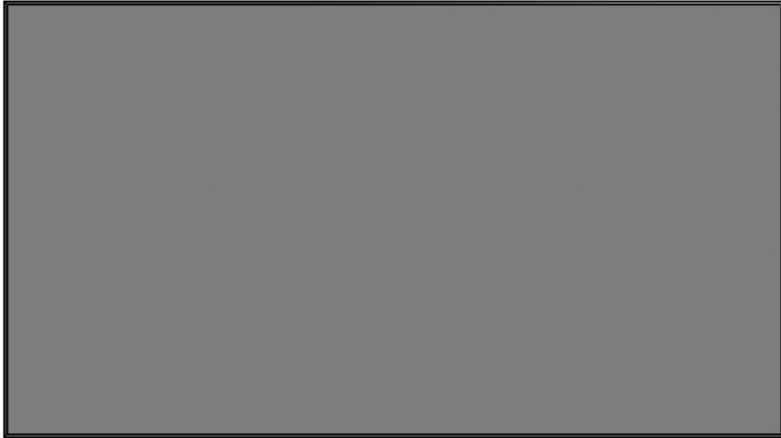

- EZ Mount Bracket System
- T-Stand (Self-Supporting)

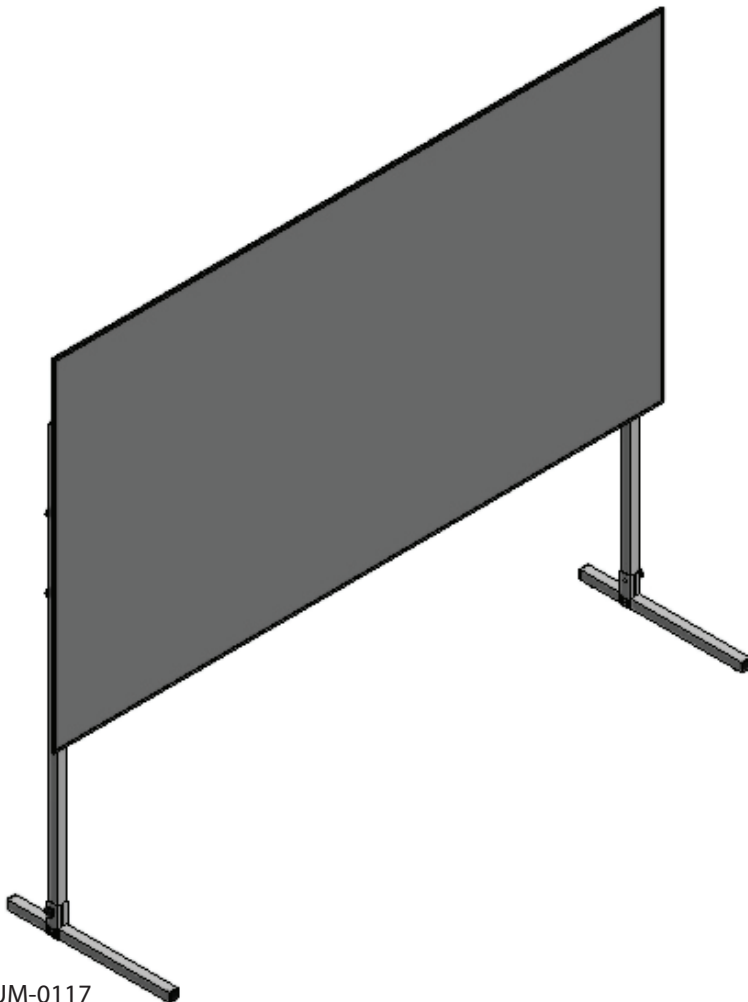

LUM-0117

Printed in U.S.A.

© 2017 Stewart Filmscreen Corporation

Stewart Filmscreen reserves the right to make changes to the product specified in this document. Sizes and specifications subject to change without notice at Manufacturer's discretion. From time to time, this document is updated. Current versions of documentation are posted on the Stewart Filmscreen website at:

www.stewartfilmscreen.com

Contents

To the Owner 4

Preparing the Installation 5

EZ Mount Bracket System 6-7

T-Stand (Self-Supporting) 8

Optional LED Light Kit..... 9

Caring for & Cleaning the Screen 10

Troubleshooting..... 11

Maintenance Notes 12-13

Product Warranty..... 14

TO THE OWNER

Congratulations on your purchase of one of the finest optical viewing screens available anywhere in the world!

Please take a moment to review this manual, it will help ensure you many years of reliable service from your new Stewart Filmscreen product.

About the LuminEsse

LuminiEsse fits modern expectations for more viewing image and less visible framing, providing a sleek appearance, even when not being viewed. The LuminEsse front-projection wall screen features an optional LED backlighting kit that goes beyond wow factor to make viewing more comfortable. Scientifically speaking, the LED lighting acts as bias lighting, relaxing the iris of the eye and causing less strain during extended viewing. When the screen is on, the multicolored perimeter lighting enriches onscreen content and when off, it can be used to set the mood of the room.

Available in sizes up to 120-inches (diagonal) in HD formats and in sizes up to 151-inches (diagonal) in Cinemascope® configurations, the LuminEsse rigid front projection screen system utilizes Stewart's wall mount system, making screen installation inexpensive, simple and fast.

Using this manual for installation

If you are using this manual to install the LuminEsse, be aware that it describes procedures for two types of mounting options. Refer to the appropriate section for either mounting option.

- ◆ EZ Mount Bracket System
- ◆ T-Stand (Self-Supporting)

PREPARING THE INSTALLATION

Before proceeding with the installation of this screen, take time to thoroughly read and understand these installation instructions.

Preparation

Specifications regarding the individual screen dimensions, weight, etc. are provided by the factory when the unit is ordered.

Before beginning the installation:

- ◆ Make sure there is a clean surface on which to lay the screen.
- ◆ Check the size and weight of the screen to be installed so that you can plan for the number of people required for installation. You need at least two people to mount the smaller screens; more are needed for larger, heavier screens.

You will need:

- ◆ Lint-free, clean cloth gloves for handling the screen
- ◆ Ladders for the personnel supporting the screen during the mounting process
- ◆ A level
- ◆ Fasteners appropriate for the surface on which the screen is being mounted
- ◆ A drill
- ◆ Tools for tightening fasteners

Note: Bolts and other fasteners for the screen are standard gauge and sizes used in the U.S., regardless of where they will be installed. For this reason, the sizes are expressed in inches rather than metric measurements.

Unpacking

Be sure to unpack carefully in a clean area. Use special care when handling the screen so that it does not become soiled or damaged. If you plan to repack your screen and hardware for transportation to another location, you may wish to photograph or make a note of how it was packed. Keep the packing material.

EZ MOUNT BRACKET SYSTEM

Professional mounting techniques should be used. Stewart Filmscreen can not be liable for standard or faulty installations.

Caution:

◆ Be careful not to touch or scratch the viewing surface

1. Identify the location of wall studs where you can securely mount the hanging bar.
2. Use a level to accurately position the hanging bar on the wall.
3. Drill holes through the bar into the studs.
4. Use the provided 2" screws or other appropriate fasteners to secure the hanging bar to the wall studs.

Note: A minimum of three (3) screws are recommended to safely secure the frame.

5. Check to make sure the bar is level.
6. Hang the screen on the hanging bar to ensure that it is correctly mounted.
7. Mark on the wall where you will mount the steel pucks to studs that will align with the magnets fastened on the frame.

Notes: Find studs that allow the pucks and magnets to be positioned approximately 12" to 24" from the edge of the frame on each side.

If the wall is not perfectly flat, the force of the magnet may cause the frame to bend. For this reason, shims can be used to place between the wall and the steel pucks so that the frame lays completely flat.

8. Remove the frame. Drill into the studs and mount the steel pucks with the provided 2-3/8" screws or other appropriate fasteners. Use shims as needed.
9. Reposition the frame, slide and secure the magnets so that they align with the steel pucks mounted on the wall.
10. Your LuminEsse is now ready to hang in its final position. See figures 1-3 on page 7.

EZ MOUNT BRACKET SYSTEM (CONTINUED)

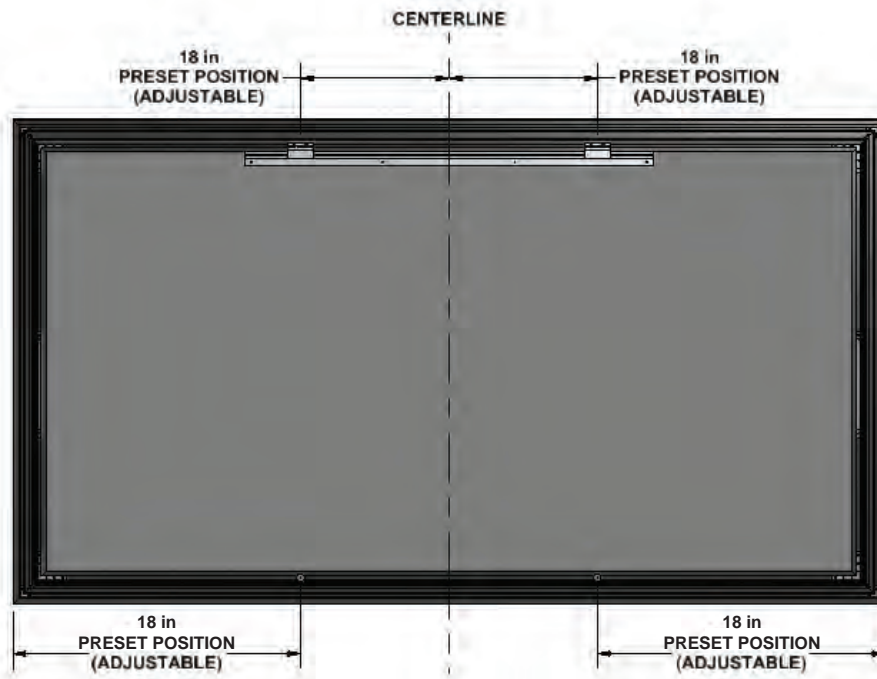

Figure 1: LuminEsse with Fitted Hanging Bar - Rear View

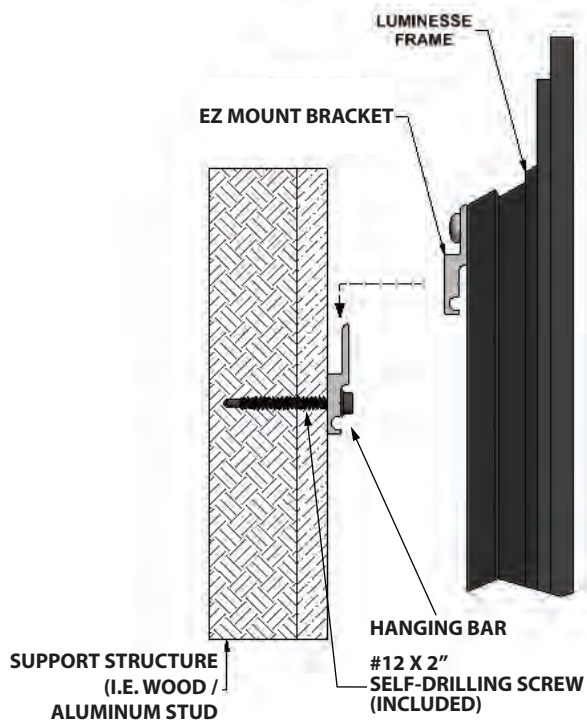

Figure 2: Wall Mounting - Side/Top View

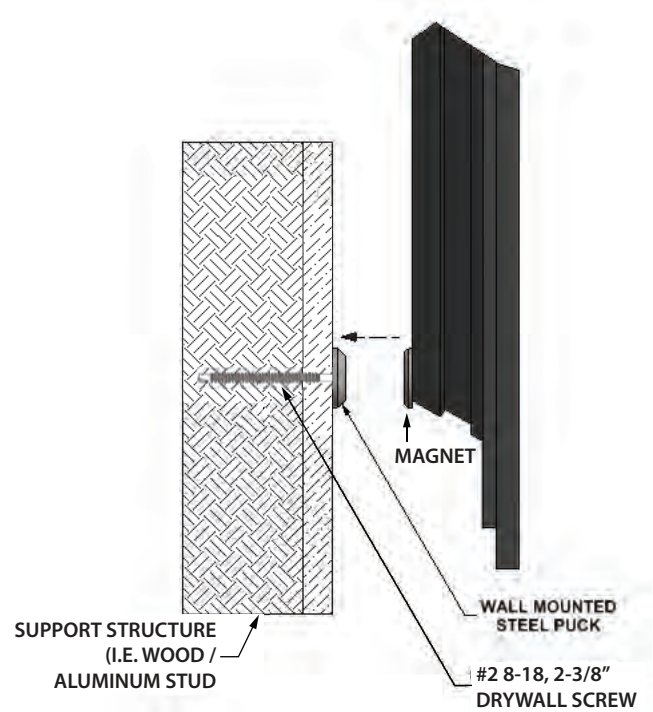

Figure 3: Wall Mounting - Side/Bottom View

T-STAND (SELF-SUPPORTING)

Professional mounting techniques should be used. Stewart Filmscreen can not be liable for standard or faulty installations.

- 1) Use the T-Stand knobs provided to first attach the vertical members to each base, and then to attach the finished screen to the T-Stands. The through holes on each vertical member should run parallel to the base.
- 2) Hand-tighten the knobs

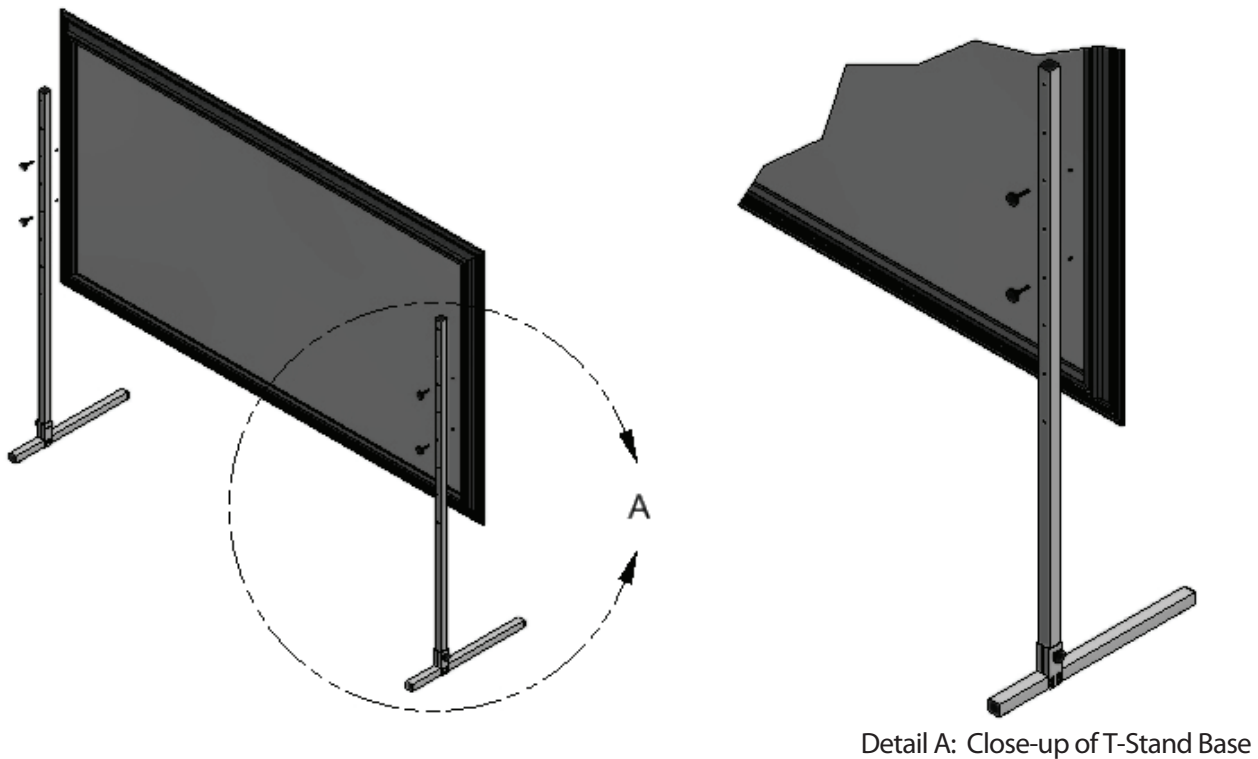

Figure 4: Attaching T-Stand knobs, standard screen attachment

Caution:

- ◆ **Be careful not to touch or scratch the viewing surface**

OPTIONAL LED KIT CONNECTIONS & OPERATING INSTRUCTIONS

Technical Parameters (remote control):

- Power supply AAA batteries (2)
- Cover material ABS

Technical Parameters (controller):

- Working voltage DC12V-24V
- Output control 3 circuits (R/G/B)
- Control current 6A/circuit
- Connection method Common anode
- Dimensions L85xW45xH22mm
- Receiving range 30 meters

Functions of Keys:

- Key 1 on/off
- Key 2 light changing mode (15 modes)
- Key 3 color light/white light switching mode
- Key 4 turn up (brightness/speed)
- Key 5 turn down (brightness/speed)

How to Use:

- Plug in unit (Please note standard, provided power supply is capable of handling 100-240V AC at 1.5A and 50/60Hz, designed for a standard U.S. receptacle. Please contact a Stewart representative for additional help.)
- Press Key 1 to turn on/off in any state
- Press Key 2 to activate light changing mode, keep pressing for different programs. There are 15 programs in total. (See Color Mode Chart below)
- Press Key 3 once to activate white light mode, you can change brightness by pressing Key 4 or Key 5. Press Key 3 twice to activate color ring, changing brightness by pressing Key 4/Key 5 or changing light color by touching the color ring.
- To match the remote control to the receiver (you do not need to do this when first out of the box), press Key 4 once when first switched on within three seconds. The light will blink 3 times to indicate that the remote control is matched.

Clearing Code:

Press Key 4 five times when first switched on, again, the light will blink six times if clearing is successful.

Color Mode Chart:

1	Auto color changing	8 grades of brightness to adjust by pressing Key 4 or Key 5.			
2	Three colors jump to change	8 grades of speed to adjust by pressing Key 4 or Key 5	9	Green color jumps to change	8 grades of brightness to adjust by pressing Key 4 or Key 5
3	Seven colors jump to change		10	Yellow color jumps to change	
4	Three colors jump to gradual change		11	Cyan color jumps to change	
5	Seven colors jump to gradual change		12	White color jumps to change	
6	Red color jumps to change		13	Red/blue light twinkles alternately	
7	Blue color jumps to change	14	Green/blue light twinkles alternately		
8	Purple color jumps to change	15	Red/green light twinkles alternately		

CAUTION: Do not cover the color ring with your hand while installing the batteries.

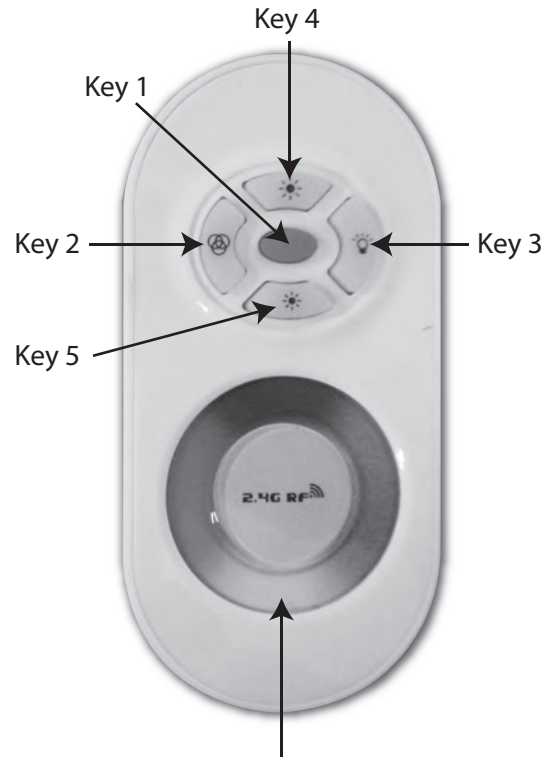

You can move your finger to choose any color you like along this color ring.

CARING FOR AND CLEANING THE SCREEN

With reasonable care, you may expect many years of dependable use of your Stewart projection screen.

General Maintenance

The surface of your screen is delicate, so we encourage you to keep your screen clean. Special attention to these instructions should be followed when cleaning.

- ◆ Avoid getting any foreign objects on the screen, as cleaning may prove very difficult. It may not be possible to remove scratches, paint, ink, etc.
- ◆ A draftsman-style brush may be used to lightly whisk away any loose dirt or dust particles. (This type of brush is usually available at office supply stores.) Stewart Filmscreen has an optional screen cleaning kit that contains the proper type of brush. Contact your dealer if you would like to obtain this cleaning kit.
- ◆ For tougher spots, you can make a cleaning solution using a water-based detergent and warm water. To make the solution, mix one part Simple Green, 409, or other water based industrial cleaner with three parts warm water. Moisten a clean cotton cloth or Q-Tip with this solution, moisten the stained area, and gently lift off the stain. Never use an aggressive scrubbing action as you could damage the screen surface by removing the optical coating. Remoisten the area with clean water and dab dry with a clean sponge or cotton cloth. Any residual watermarks will evaporate on their own in a few minutes.
- ◆ Contact the factory if you have questions about removing difficult spots.

Caution

- ◆ Do not use any other cleaning materials on the screen.
- ◆ Do not use chemicals or solvents to clean the screen. Use only commercially available, water-based de-greaser.

Replacement Parts & Service

No user-serviceable parts are contained within the unit. Contact your dealer or the factory if you require part replacement or service.

TROUBLESHOOTING

Problem	Cause	Action Steps
Dirt, fingerprints, marks, etc. on screen surface	Improper handling of screen	Lightly brush off or use a mild detergent solution with a clean rag or cotton swab.
LED Lights do not operate (LED Light Kit Optional)	Faulty connections or the remote transmitter is not functioning	Check voltage supply and connections. Check batteries in the remote transmitter and replace them, if needed.

LIMITED ONE YEAR WARRANTY

STEWART FILMSCREEN CORPORATION (Stewart) warrants its Stewart Filmscreen products to the original purchaser only, to be free from defects in materials and workmanship for a period of one (1) year from the date of purchase by the original purchaser or eighteen (18) months from date of manufacture, as defined in the serial number, provided they are properly operated and maintained according to Stewart instructions and are not damaged due to improper handling or treatment after shipment from the factory. This warranty does not apply to equipment showing evidence of misuse, abuse, or accidental damage, including neglect caused by improper installation (i.e. proximity to hot lights, exposure to extreme heat or cold, exposure to excessive humidity, etc.). Stewart on-site warranty repair services are not available for this product.

Stewart's sole obligation under this warranty shall be to repair or to replace (at Stewart's sole discretion) the defective part of the merchandise. This warranty expressly does not cover any costs of removal, installation, framing, or other costs incident to replacing the screen or returning it to Stewart. Returns for service should be made to your Stewart dealer. If it is necessary for the dealer to return the screen or part to Stewart, transportation (freight) expenses to and from Stewart are payable by the purchaser. Stewart is not responsible for damage in shipment. To protect yourself against damage or loss in transit, insure the product and prepay all transportation expenses.

This warranty is in lieu of all other warranties, expressed or implied, including warranties as to fitness for use and merchantability. Any implied warranties of fitness for use, or merchantability, that may be mandated by statute or rule of law are limited to the one (1) year warranty period. This warranty gives you specific legal rights, and you may also have other rights which vary from state-to-state. In no event will Stewart be liable for sums in excess of the purchase price of the product. No liability is assumed by Stewart for expenses or damages resulting from interruption in operation of equipment, or for incidental, direct, or consequential damages of any nature.

In the event that there is a defect in materials or workmanship of a Stewart Filmscreen product, you may contact our Customer Service Department at 1161 W Sepulveda Blvd, Torrance, California 90502- 2797 (310-784-5300) Toll free (800-762-4999).

IMPORTANT: This warranty shall not be valid and Stewart shall not be bound by this warranty if the product is not operated and maintained in accordance with Stewart's written instructions. Stewart Filmscreen Corporation shall not be liable for any and all consequential damage(s) occasioned by the breach of any written or implied warranty pertaining to the sale of a Stewart Filmscreen product in excess of the purchase price of the product sold.

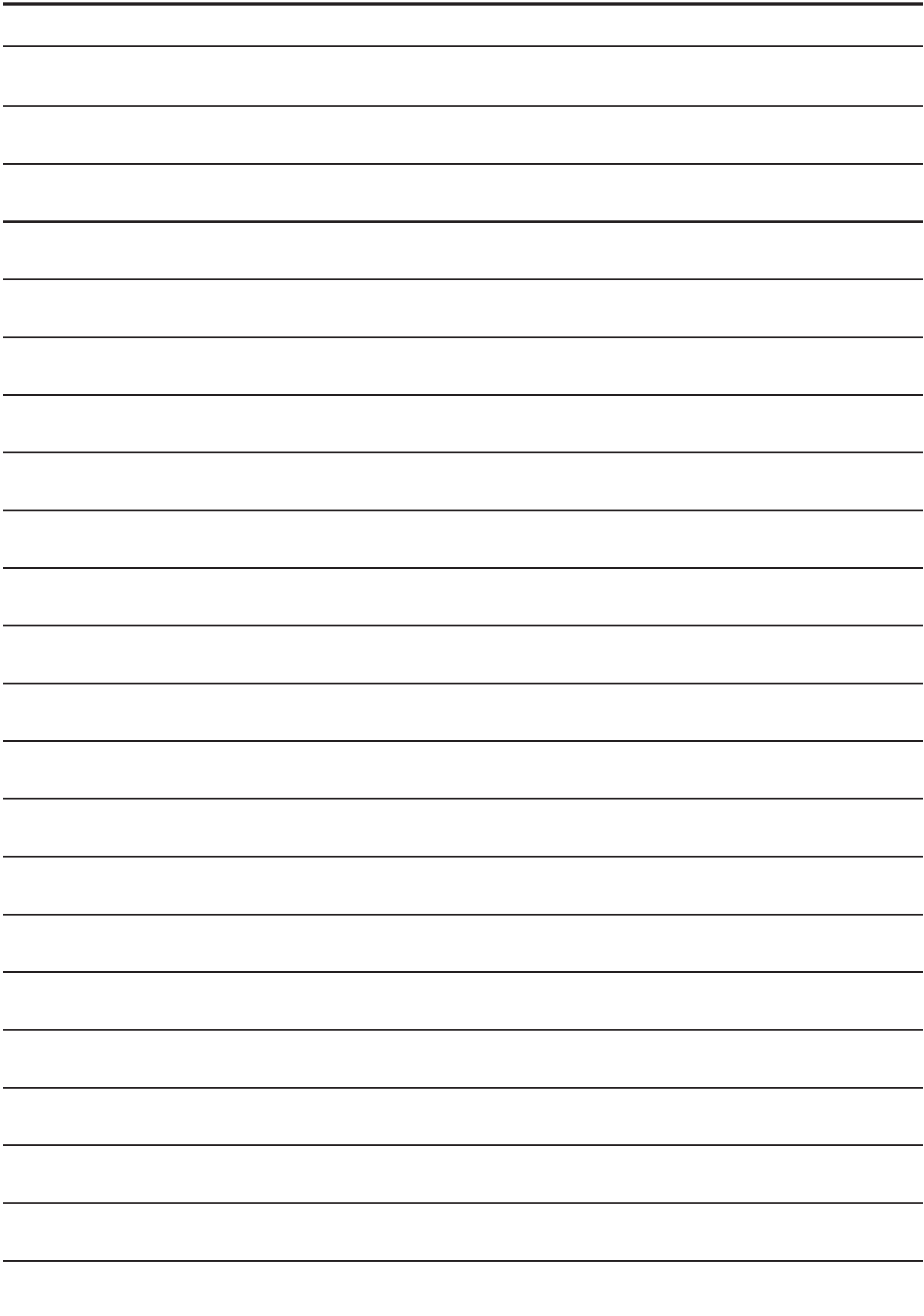

Stewart[®]
F I L M S C R E E N

800.762.4999 • 310.784.5300 • Fax: 310.326.6870
www.stewartfilmscreen.com

January 2017
Printed in U.S.A.
©2017 Stewart Filmscreen Corporation